

KRISTIN JONES AND ANDREW GINZEL
PROPOSAL FOR THE WALKER ART CENTER
MINNEAPOLIS SCULPTURE GARDEN
1987

SIDE ELEVATION
SCALE 3/4 INCH = 1 FOOT

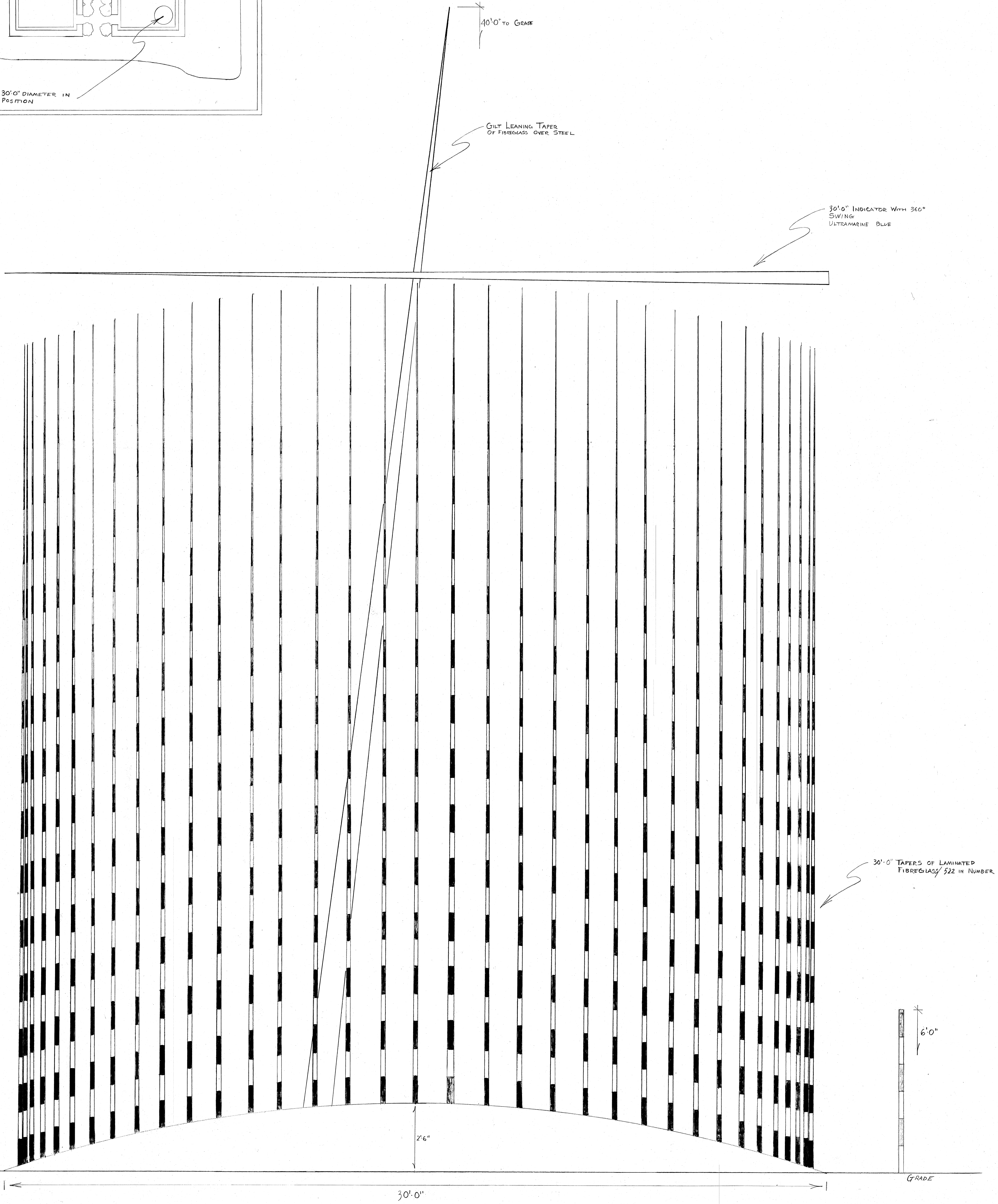
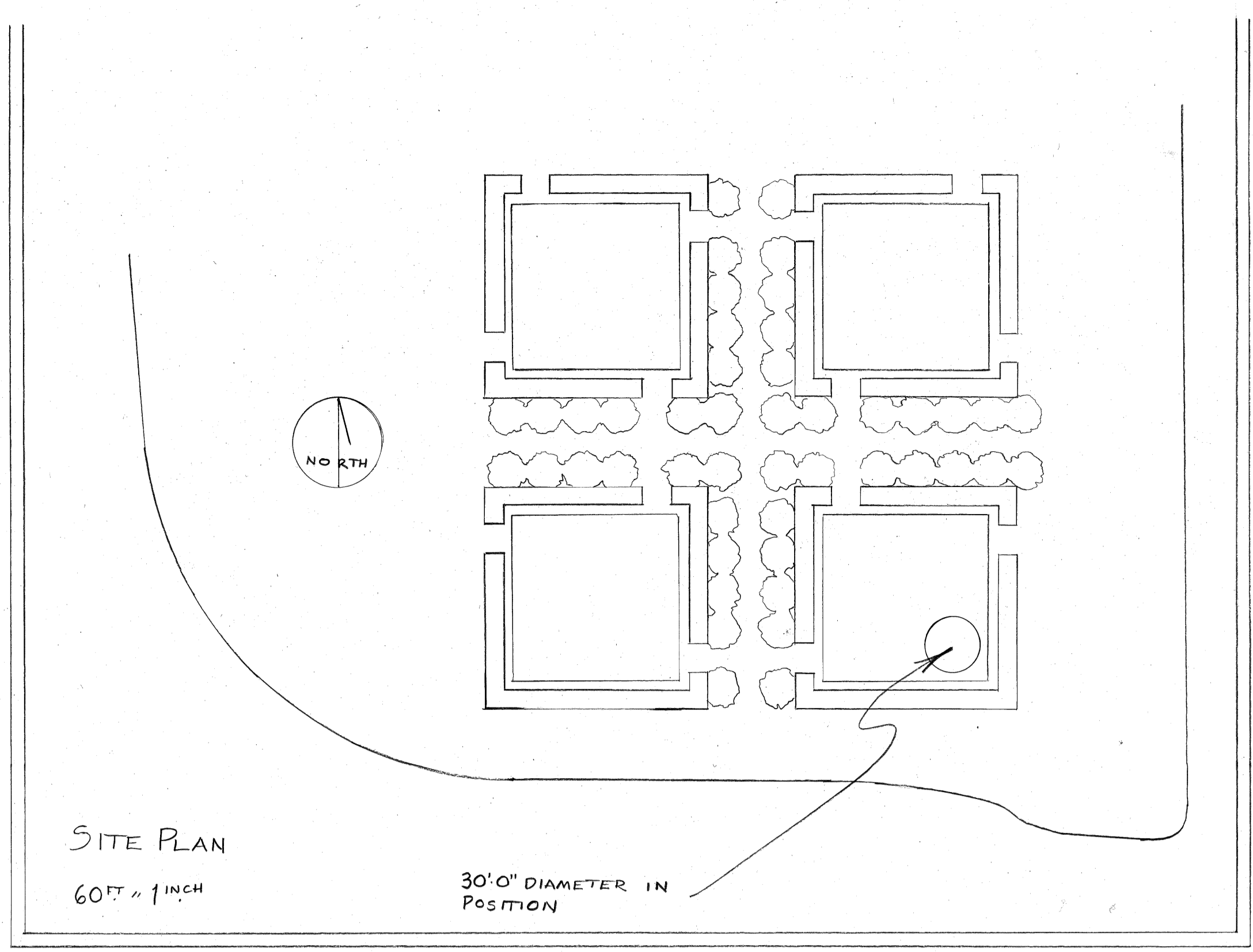

NOTE: BLACK AND WHITE TAPERS ARE SHOWN IN ONLY ONE ROW FOR CLARITY OF PRESENTATION

30' 0" TAPERS OF LAMINATED FIBREGLASS #522 IN NUMBER

30' 0" INDICATOR WITH 360° SWING ULTRAMARINE BLUE

GILT LEANING TAPER OF FIBREGLASS OVER STEEL

40' 0" TO GRADE

6' 0"

2' 6"

30' 0"

GRADE